

Meat Packing and Food Processing Chains

**RENOLD
JEFFREY**

- Smooth, quiet operation
- Long lasting, reliable performance
- Maintenance free

A Cut Above

Maximize performance of your meat packing or food-processing lines with Polymer Bushed Roller Conveyor Chains from Renold Jeffrey.

Polymer Bushed Roller Conveyor Chains from Renold Jeffrey are ideal for meat packing and food processing operations. These dependable chains are built to handle wet and washdown conditions. Polymer bushed rollers, stainless steel timbles, and plated sidebars, pins, and rollers resist corrosion and keep running. The polymer bushing material does not absorb water like some plastics, has very low friction characteristics, and will withstand hot water, steam, and detergents.

These reliable performers are furnished with K-type attachments and available in a wide range of standard and specialized materials. Lubrication is not necessary. Operation is consistent, smooth, and quiet.

Contact your local distributor or Renold Jeffrey to get the meat packing and food processing chains that are a cut above.

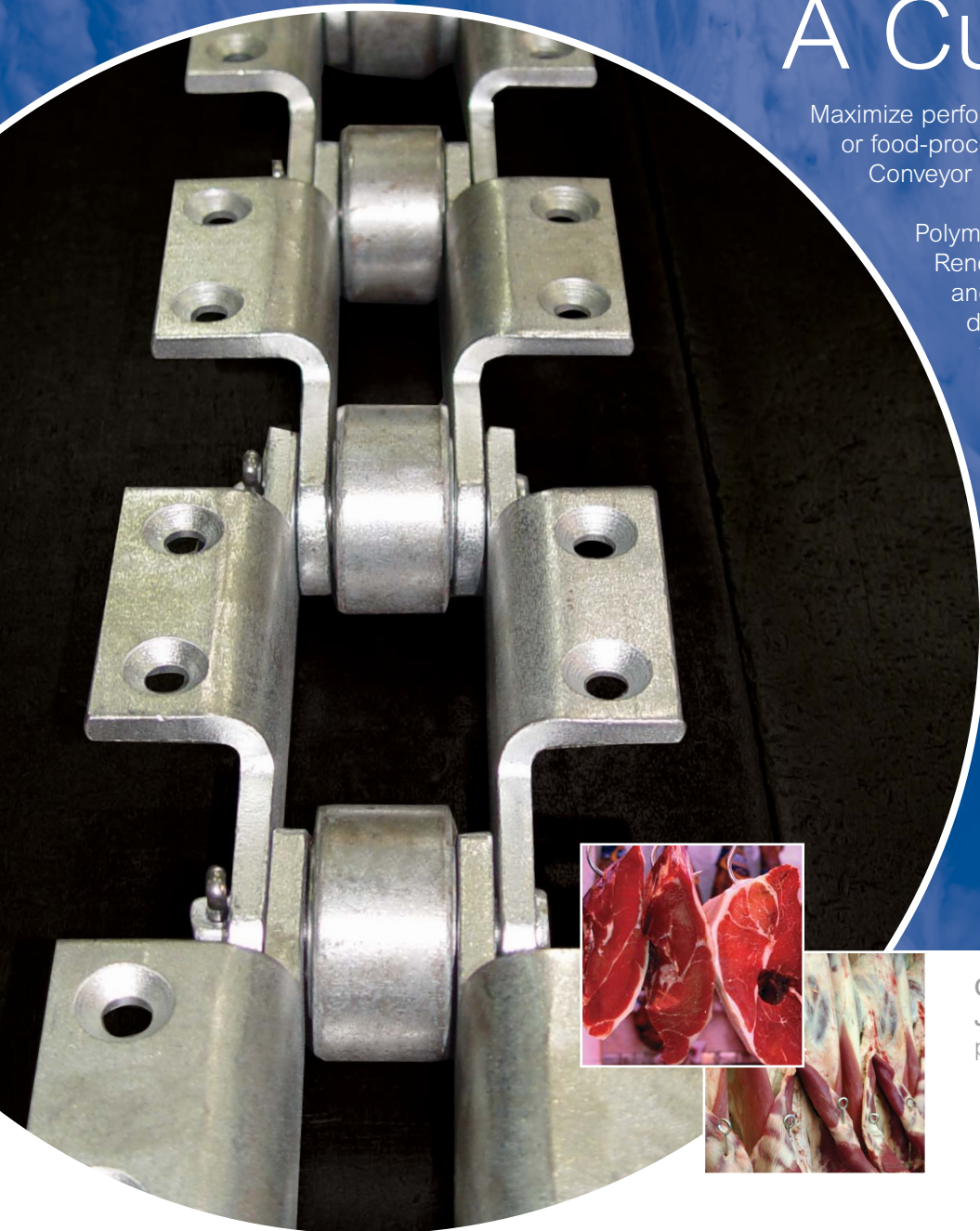

Meat Packing and Food Processing Chains

Polymer Bushed Roller Conveyor Chains

Made in America

- Available in carbon steel or stainless
- Smooth, quiet operation
- Long lasting, reliable performance
- Maintenance free

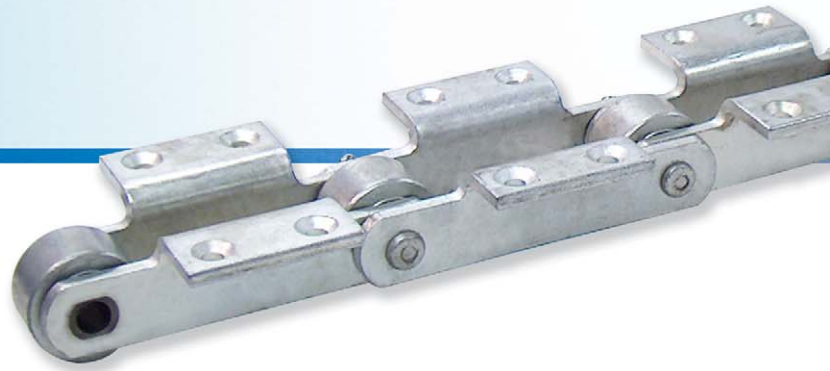

All dimensions are in inches unless otherwise specified.

Chain No.	Pitch	Rated Wkg. Value (lbs.)	K-2 Att. Avg. Wt./Ft. (lbs.)	Coupling Pin		Sidebar						Coupling Pin				Roller			Width Inside		Thimble		
				Dia.	Mtl.																Mtl.		
	P			A	B	C	D	E	F		H	J	K	L	R		S	T	W	Z			
*5401	4.040	3150	11.3	5/8	MH	1 17/64	4 1/8	3/8	5/16	1 1/2	M	1 1/4	1 7/16	1 43/64	2 11/16	2	MH	Delrin	5 1/2	5/16	1 5/16	1 1/2	SH
*5600	6.000	3150	9.2	5/8	MH	2	4	3/8	5/16	1 1/2	M	1 3/8	1 7/16	1 43/64	3 1/2	2	CC	Delrin	5 1/4	5/16	1 5/16	2	SH
*5601	6.000	3150	9.2	5/8	MH	2	4	3/8	5/16	1 1/2	M	1 3/8	1 7/16	1 43/64	3 1/2	2 1/4	CC	Delrin	5 1/4	5/16	1 5/16	2	SH
5602	6.000	1950	8.9	7/16	AH	2	4	3/8	1/4	1 1/2	M	1 1/4	1 11/64	1 21/64	3 1/4	2	MH	Delrin	4 15/16	1/4	1 1/8	2	SH

* Attachments have 3/16 x 90° countersunk holes on top of attachments.

Pins can be stainless steel or nickel plated. Other polymer materials are available for specific applications.

ABBREVIATIONS

AC—Alloy—Case-hardened
 AH—Alloy Steel—Heat-treated
 CC—Carbon Steel—Case-hardened

M—Medium Carbon Steel
 MH—Medium Carbon Steel—Heat-treated
 SH—Stainless Steel—Heat-treated

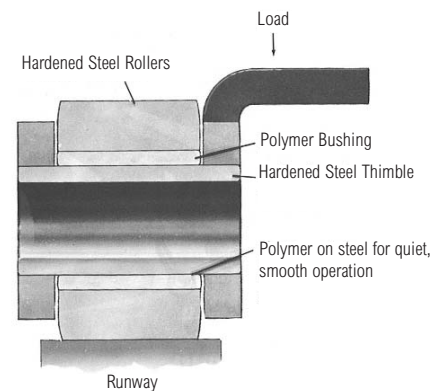
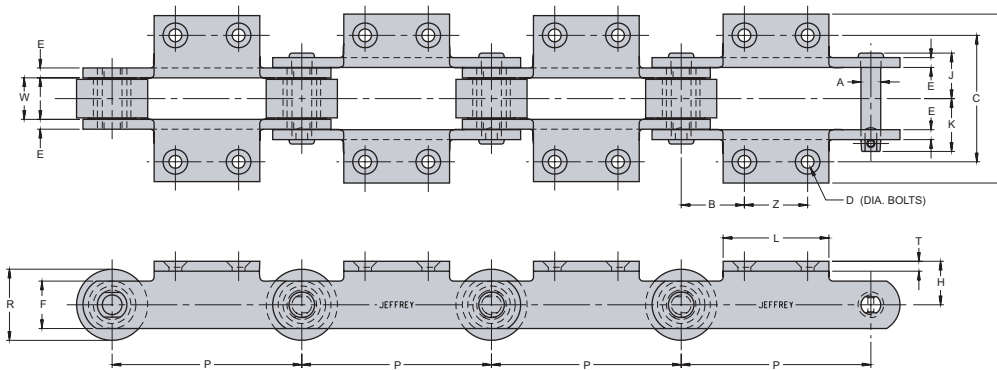

Corporate Headquarters
 2307 Maden Drive
 Morristown, TN 37813
 Tel: (423) 586-1951
 Tel: (800) 251-9012
 Fax: (423) 581-2399

National Service Center
 2305 Global Way
 Hebron, KY 41048
 Tel: (859) 334-8520
 Tel: (800) 251-9012
 Fax: (859) 334-8550

West Coast Service Center
 2301 A Stagecoach Rd.
 Stockton, CA 95215
 Tel: (209) 466-4646
 Tel: (800) 251-9012
 Fax: (209) 466-1749